

Product Description

Albi Cote DW is a water-base intumescent designed for drywall and wall assemblies to improve the hourly rating of the assembly to two hours and beyond with just a spray application. Albi Cote DW can improve labor, installation, and material costs of drywall and wall assemblies that require hourly ratings. Albi Cote DW smooth, aesthetic finish is ideal for applications in residential and commercial updates and renovations.

Recommended Uses

- Industrial plants
- Correctional Facilities
- Atriums
- Power Generating Facilities
- Hospitals
- Warehouses
- Parking Garages
- School Gymnasiums
- Food Processing Plants
- Computer Chip Manufacturing
- Convention Centers
- Sports Stadiums

Physical Properties

Color: White

Finish: Smooth

| Property | Test Method | Value |
|--------------------------------------|-------------|--------------------------------|
| Dry Applied Density | | 85 PCF |
| Hardness (Shore D) | ASTM D2240 | 60-65 |
| Cohesive / Adhesion Strength | ASTM D4541 | 300 PSI |
| Abrasion Resistance | ASTM D4060 | 0.3 Gram Loss |
| Impact Resistance | ASTM D2794 | 85 in./lbs. |
| Weight per Gallon % Solids by Weight | ASTM D1475 | 11.5 ± 0.2 Lbs./gal 72% ± 2 |
| Flame Spread | ASTM E84 | 2 – Class A |
| Smoke Development | ASTM E84 | 5 – Class A |

Handling and Packaging

Product shipped by 5-gal pail or 55-gal drum store indoor in a dry environment between 45°F and 105°F (7°C- 40°C).

5-gal pail shipping weight is 62 lbs.

12 Months shelf life.

Product must be stored in a dry environment with temperatures between 33°F (1°C) and 100°F (38°C). The shelf life of the material is 12 months in unopened, sealed containers, properly stored

Application Procedures

Surface Preparation

Albi Cote DW shall be directly applied to surfaces that have been properly prepared to receive this coating. The surfaces must be clean and dry, free from rust, grease, dust, or other contaminants that will interfere with proper bonding.

All drywall surfaces shall be prepared with a Level 2 Drywall Finish that requires tape and joint compound to seal the drywall joints.

Airless Spray Equipment

Albi Clad TF+ can be applied by brush or spray application. We recommend application with airless spray equipment. Any pumps used must be rated for a minimum material delivery of 1.25 gallons per minute to provide an operating pressure of 3,000 PSI (210 kg/cm²) Spray tips 0.021" - 0.025". Hose length 50' (15 m) maximum

Application

Albi Cote DW is spray applied directly from the shipping container with a quick stir. Albi Cote DW can be top coated with many commercially available paints and coatings to meet color and physical property specifications. Albi Cote DW requires a level 2 drywall finish to smooth over existing drywall, tape exposed drywall edges, and to allow for a clean easy to stick to surface. If you have questions on topcoats or drywall finish level, contact Albi Protective Coatings.

Do not apply Albi Cote DW below 50°F or above 100°F as elongated dry times or sagging can occur. Do not store or transport Albi Cote DW below 33°F as the material can freeze. Do not store and transport Albi Cote DW above 100°F. Care must be taken to protect the Albi Cote DW immediately after application and after dry time from direct rainfall. Albi Cote DW is to be used in interior applications only. Please refer to the Albi Cote DW Application Guide for further details. Thickness of the application will depend upon the fire endurance rating specified. Albi Cote DW must be applied by qualified applicators, utilizing standard airless spray equipment. Installation must be in accordance with manufacturer's printed instructions, and in compliance with specific test requirements.

Storage & Handling

Apply product when the ambient air temperature is between 50°F (10°C) and 100°F (38°C). A minimum ambient and substrate temperature of 50°F (10°C) must be maintained during and a minimum of 72 hours after application. Steel surface temperature must be a minimum 4°F (2°C) above the dew point to prevent condensation from forming. The maximum steel temperature is 100°F (38°C).

Top coating

Overcoating is not required with Albi Cote DW. However, if a topcoat is required for color-coding, aesthetics or additional surface protection against spills, a suitable topcoat shall be used. For unusually severe environments consult the fireproofing manufacturer for recommendations of appropriate topcoats.

Fire Resistance Construction & Required Cover Rates

- 2-Hour Wall Assembly Construction – Option 1
 - Front face:
 - 45 dry film thickness of Albi Cote DW - 21.38 square feet per gallon coverage rate
 - One layer of 5/8" Type X drywall
 - Level 2 drywall finish using tape and joint compound over the sheetrock joints.
 - 1 & 5/8" Type W screws at 12" on center spacing.
 - Interior Construction:
 - 12"x4" wood studs with 12" on center spacing.
 - Back Face:
 - 1 Two layer of 5/8" Type X drywall
 - 1 & 5/8" Type W screws at 12" on center spacing.

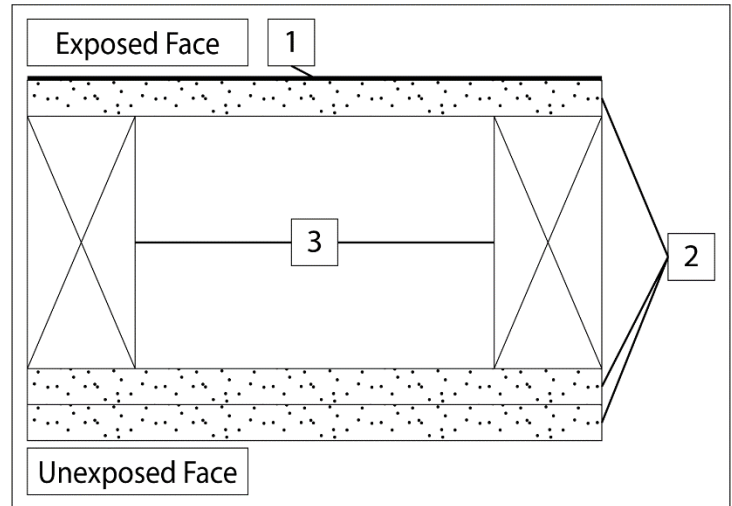

- 2-Hour Wall Assembly Construction – Option 2
 - Front face:
 - 45 dry film thickness of Albi Cote DW - 21.38 square feet per gallon coverage rate
 - One layer of 5/8" Type X drywall
 - Level 2 drywall finish using tape and joint compound over the sheetrock joints.
 - 1 & 5/8" Type W screws at 12" on center spacing.
 - Interior Construction:
 - 2"x4" wood studs with 12" on center spacing.
 - 1" mineral fiberboard insulation with an R-value between 4-5.
 - Back Face:
 - One layer of 5/8" Type X drywall
 - 1 & 5/8" Type W screws at 12" on center spacing.

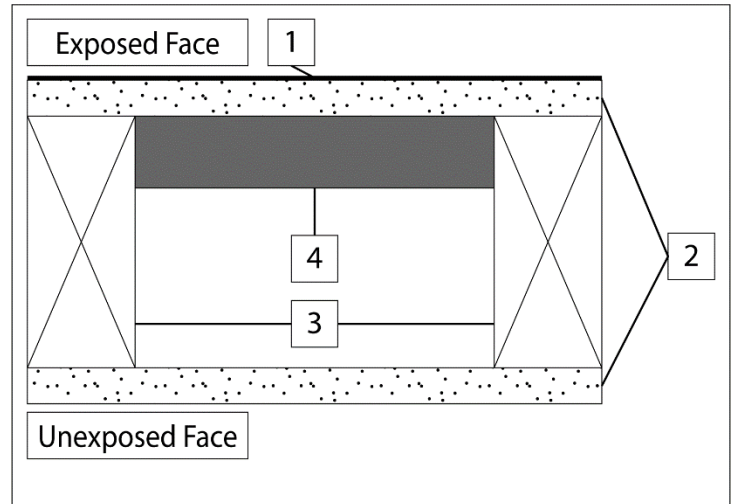

Refer to the Application Manual and Field Guide for further details.